

Bose® QuietComfort® 2 Acoustic Noise Cancelling® Headphones

Owner's Guide

Brugervejledning

Bedienungsanleitung

Guía de usuario

Notice d'utilisation

Manuale di istruzioni

Gebruiksaanwijzing

Bruksanvisningen



Safety Information

Please read this owner's guide

Please take the time to follow the instructions in this owner's guide carefully. It will help you to properly use your new Bose product and enjoy its features. Please save this owner's guide for future reference.

▲ WARNINGS

- *Long-term exposure to loud music may cause hearing damage. It is best to avoid extreme volume when using these headphones, especially for extended periods.*
- *Keep batteries out of reach of children.*

▲ CAUTIONS

- *Do not use these headphones when operating a motor vehicle on a public road, or where the inability to hear outside sounds may present a danger to the user or others.*
- *Sounds that you rely on as reminders or warnings may have an unfamiliar character when you are using the headphones. Be aware of how these sounds vary in character, so you can recognize them as needed.*
- *Do not drop, sit on, or allow the headphones to be immersed in water.*

Please dispose of used batteries properly, following any local regulations. Do not incinerate.



CE This product conforms to the EMC Directive 89/336/EEC and to the Low Voltage Directive 73/23/EEC. The complete Declaration of Conformity can be found on www.Bose.com/static/compliance/index.html.

Using Your Headphones

For noise reduction and audio

Use the supplied headphones cord to enjoy both audio and noise reduction. Please note that the **LEVEL** switch on the plug is used to adjust the output volume of different audio sources.

1. Set the **LEVEL** switch on the headphones cord to appropriate setting for your audio source.

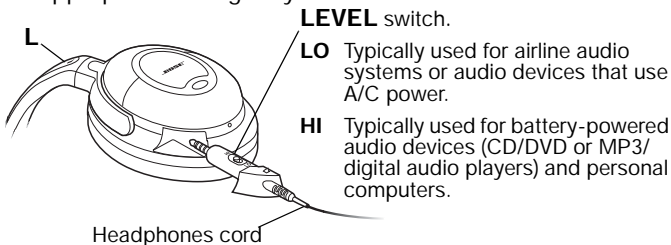

Note: The HI and LO settings have no affect on noise reduction.

2. Insert the headphones cord into the opening on the left (L) earcup. Push the plug in so it is flush with the side of the earcup.
3. Connect the headphones cord to your audio source. Refer to "Connecting to portable and home audio devices" on page 5.
4. Put on the headphones and turn on the power switch.
5. Use the volume control on your audio source to make further volume adjustments.

For noise reduction only

If you plan to use them for noise reduction only, simply put on the headphones and turn on the power switch, located on the right earcup. The headphones cord is not required.

Using Your Headphones

Connecting to portable and home audio devices

The 3.5 mm plug on the headphones cord allows you to connect your headphones to a variety of audio devices that use a single 3.5 mm output jack such as a CD, DVD, MP3/digital audio player, or personal computer. Set the **LEVEL** switch to **HI** and plug the headphones cord directly into the 3.5 mm output jack.



To connect to a home stereo system that has a ¼ in (6.3 mm) stereo output jack, use the the ¼ in (6.3 mm) stereo adapter plug included with your headphones. Set the **LEVEL** switch to **LO**. Plug the headphones cord into the adapter plug and insert it into the output jack on your stereo system.



Connecting to airline audio systems

The audio output connections on airline audio systems vary, but they typically have dual or single 3.5 mm output jacks.



Note: Airline audio may not equal the high quality audio you experience from a home stereo or portable source.

Connecting to dual output jacks

Set the **LEVEL** switch to **LO**. Plug the headphone cord into the dual-plug adapter and insert it into the dual output jacks.



Connecting to a single output jack

Set the **LEVEL** switch to **LO**. Plug the headphone cord into the adapter and insert it into the single output jack.



The LO setting of the LEVEL switch lowers the volume levels of strong audio output signals which are common on airline systems. If you find that the volume level is too low, set the LEVEL switch to HI.

Care and Maintenance

Folding the earcups for storage

QuietComfort® 2 Acoustic Noise Cancelling® headphones feature rotating earcups that fold flat for easy, convenient storage. The earcups rotate in one direction only.

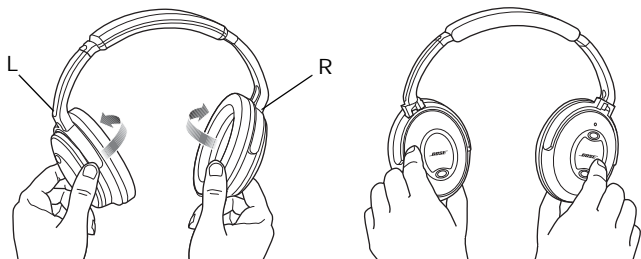

CAUTION: Incorrectly rotating the earcups can damage the headphones.

Reattaching earcup cushions

The earcup cushions are held in place by a mounting flange. This flange snaps under small tabs located around the inside rim of the earcup.

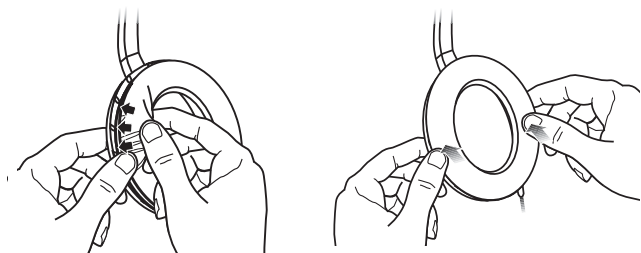

If an earcup cushion becomes partially or completely detached, push its mounting flange back into the earcup. Then use your finger or thumb to press around the edge of the mounting flange, making sure it snaps into place all the way around the earcup.

Battery replacement

Although it varies by usage, battery life averages 35 hours. With the headphones turned on, the battery light indicator will flash when there are approximately 8 hours of battery life remaining.

When a replacement is needed, use 1 AAA alkaline battery (IEC LR03). Tilt the top of the right earcup inward to gain access to the battery compartment.

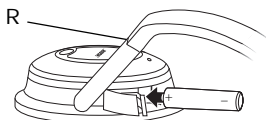

Note: You can use rechargeable batteries (NiMH, composed of nickel metal hydride, are recommended). They average half the life of alkaline batteries. However, the low battery indicator light is not set for such batteries and will not be a reliable indicator of their remaining battery life.

Replacement parts and accessories

You can purchase accessories from your Bose dealer, on the internet (www.Bose.com), or by placing an order over the phone. See the inside back cover for contact information.

- Dual plug adapter
- Headphones cord
- 1.5 m extension cord
- 6.2 m extension cord
- Deluxe carry case
- Replacement ear cushion kit
- Accessory kit (includes adapters, extension cord, and two AAA batteries)
- QC2 Cell Connect Accessory Kit

Care and Maintenance

Cleaning the headphones

Scheduled cleaning is not required. However, you can simply wipe the outside surfaces with a damp cloth, as needed. Also, be sure that the earcup ports are clear and that no moisture is allowed into the earcups.

Troubleshooting

Problem	What to do
No noise reduction	<ul style="list-style-type: none">• Turn on the headphones• Check battery
Low or no volume	<ul style="list-style-type: none">• Turn source volume up• Set LEVEL switch to HI• Check headphones cord connection at the source and the earcup
Crackling noise; intermittent loss of noise reduction	<ul style="list-style-type: none">• Replace the battery
Low rumbling	<ul style="list-style-type: none">• Adjust how the headphones fit on your ears• Make sure earcup ports are clear
Volume too high	<ul style="list-style-type: none">• Turn source volume down• Set LEVEL switch to LO

Aviation Communication Headset Needs

While QuietComfort® 2 headphones are designed for passenger use in air transport aircraft, they are not engineered to meet the needs of pilots or to meet civil aviation authority standards for communication headsets.

WARNING: *Except in case of emergency, Bose recommends that you NOT use these headphones as aviation communication headsets because:*

- *No incoming audio will be heard with a discharged or improperly installed battery. This could result in the potential of missed communications while piloting an aircraft.*
- *Extremely loud ambient noise levels that are common to many propeller-driven aircraft may impair the user's ability to receive incoming audio communications, particularly during takeoff and climb out when noise levels are high.*
- *The QuietComfort 2 headphones are not engineered for the altitude, temperature or other environmental conditions common in non-commercial aircraft, resulting in possible interference to critical communications.*

For pilots, Bose offers a communication headset which is specifically designed to meet or exceed civil authority standards. It features a microphone with the appropriate power and intelligibility for transmission of flight information. It is also engineered to withstand the altitude and temperature conditions that are common in non-commercial aircraft.

For more information on products for pilots, please contact Bose Corporation using the information supplied on the inside back cover of this owner's guide.

Bose Corporation

Australia

Phone: 1 800 023 367
www.Bose.com.au

Belgique/België

Phone: 012 390800
Fax: 012 390840

Canada

Phone: 1-800-465-2673
Fax: 1-800-862-2673
www.Bose.ca

China

Phone: 86-22-62713000, x162
Fax: 86-21-62713008

Danmark

Phone: 04343-7777
Fax: 04343-7818

Deutschland

Phone: +49-5921-724142
Fax: +49-5921-724251
www.Bose.de

France

Phone: 01-30616363
Fax: 01-30616382
www.Bosefrance.fr

India

Phone: 1 600 11 2673
Fax: 91 11 2307 3823
www.Boseindia.com

Ireland

Phone: (042) 9671500
Fax: (042) 9671501
www.Bose.ie

Italia

Phone: 06 60 292 292
Fax: 06 60 292 119
www.Bose.it

Japan

Phone: 0120-130-168
Fax: 03-5489-1069
www.Bose.co.jp

Mexico

Phone: +52 (55) 52 02 35 45
Fax: +52 (55) 52 02 41 95

Nederland

Phone: 0299-390111
Fax: 0299-390109
www.Bose.nl

New Zealand

Phone: 0800 501 511

Norge

Phone: 62 82 15 60
Fax: 62 82 15 69

Österreich

Phone: 01-60404340
Fax: 01-604043423

Schweiz

Phone: 061-9757733
Fax: 061-9757744

Sverige

Phone: 031-878850
Fax: 031-274891

United Kingdom

Phone: 0870 7414500
Fax: 0870 7414545
www.Bose.co.uk

United States

Phone: 1-888-757-9943
Fax: 1-877-289-4366
www.Bose.com

World Wide Web

www.Bose.com
www.Boseeurope.com

